



ONE WELL KNOWN SEQUENCE-0101
PENDANT, 2017

Black Anodised Satin Aluminium and Inox Anodised Satin Aluminium
Pendant rod length to order



OVERALL DIMENSIONS

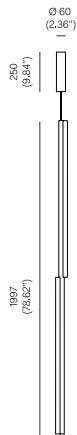

MATERIAL/FINISH

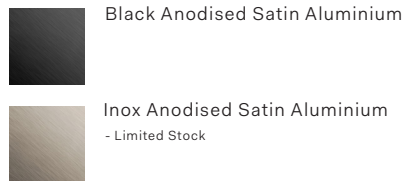

CLEANING INSTRUCTIONS

Before cleaning, lighting fixtures must be turned off and unplugged from mains electricity. Whilst cleaning please take care and use the gloves provided.

Anodised Satin Aluminium: Use a lightly damp soft dust cloth and gently go over marks until clean. Dry it afterwards with a soft dust cloth.

Glass tube: Remove the bulb from the product. Using a lightly damp cloth, clean only the outside of the tube and dry it with a dry soft dust cloth. Only put the glass bulb back on the product once it is fully dry.

LIGHT SOURCE SPECIFICATIONS

240V S14S LED Radium Raledina 1000mm
9.9W / 1055lm / 2700K / 80CRI
Maximum wattage: 10W

PRODUCT SPECIFICATIONS

Input voltage: 240V only
Maximum wattage: 20W
240V dimmable LED triac
Product weight: 10kg
IP 20 Indoor use only
(suitable for bathroom Zone 3)

BACKPLATE DIMENSIONS

Mounting screws not included

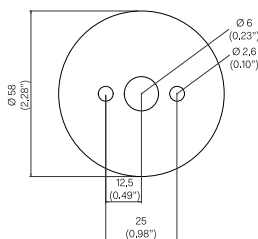

Please supply required drop length of fixture, measured from the ceiling to bottom fitting at time of order.

Minimum total drop length 2350mm.
Maximum total drop length 4040mm.
Please allow 25mm tolerance of drop length.