



ONE WELL KNOWN SEQUENCE -01  
PENDANT, 2017

Black Anodised Satin Aluminium and Inox Anodised Satin Aluminium  
Pendant rod length to order



OVERALL DIMENSIONS



BACKPLATE DIMENSIONS

Mounting screws not included

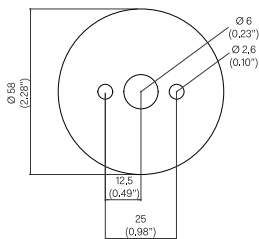

MATERIAL/FINISH

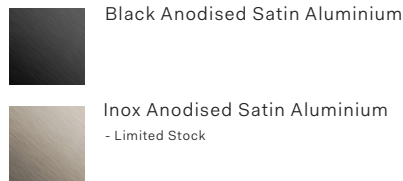

LIGHT SOURCE SPECIFICATIONS

240V S14S LED Radium Raledina 1000mm  
9.9W / 1055lm / 2700K / 80CRI  
Maximum wattage: 10W

PRODUCT SPECIFICATIONS

Input voltage: 240V only  
Maximum wattage: 10W  
240V dimmable LED triac  
Product weight: 6kg  
IP 20 Indoor use only  
(suitable for bathroom Zone 3)

Please supply required drop length of fixture,  
measured from the ceiling to bottom fitting at  
time of order.

Minimum total drop length 1350mm.  
Maximum total drop length 3040mm.  
Please allow 25mm tolerance of drop length.

CLEANING INSTRUCTIONS

Before cleaning, lighting fixtures must  
be turned off and unplugged from mains  
electricity. Whilst cleaning please take care  
and use the gloves provided.

Anodised Satin Aluminium: Use a lightly damp  
soft dust cloth and gently go over marks until  
clean. Dry it afterwards with a soft dust cloth.

Glass tube: Remove the bulb from the  
product. Using a lightly damp cloth, clean only  
the outside of the tube and dry it with a dry  
soft dust cloth. Only put the glass bulb back  
on the product once it is fully dry.